

INSTRUCTION MANUAL

AUTO INTERLOCK IV

AUTOMATIC TRANSFER SWITCH



MODEL #091-197

INPUT: 120/240 VOLTS, 50/60 HZ AC, 50 AMPS

PROOF OF CONCEPT



KUSSMAUL ELECTRONICS CO., INC.

170 CHERRY AVE., WEST SAYVILLE, N.Y. 11796

Telephone: **631-567-0314**

Toll Free: **800-346-0857**

Fax: **631-567-5826**

Web: www.kussmaul.com

E-Mail: sales@kussmaul.com

INTRODUCTION

The Model 091-197 Auto Interlock IV is an automatic power transfer relay designed to switch loads from shoreline to an auxiliary input, typically a generator. As soon as voltage from the auxiliary input is sensed a delay-on-operate relay is initialized. The delay-on-operate is a factory programmed timer, which delays the transfer switch operation. Once activated the delayed relay energizes the transfer relay coils and the output is disconnected from the main input and connected to the auxiliary input.

INSTALLATION

1. Open hinged cover.
2. Wire in accordance with FIGURE 1 using cable strain relief clamps.
3. Ensure external wire AWG is sufficient to carry 50 Ampere load current.
4. Reinstall cover.

Model: 091-197

Input Voltage: 120/240 Volts A.C, 50/60 Hz

Input Amps: 50 Amps Max.

Weight: 8 lbs.

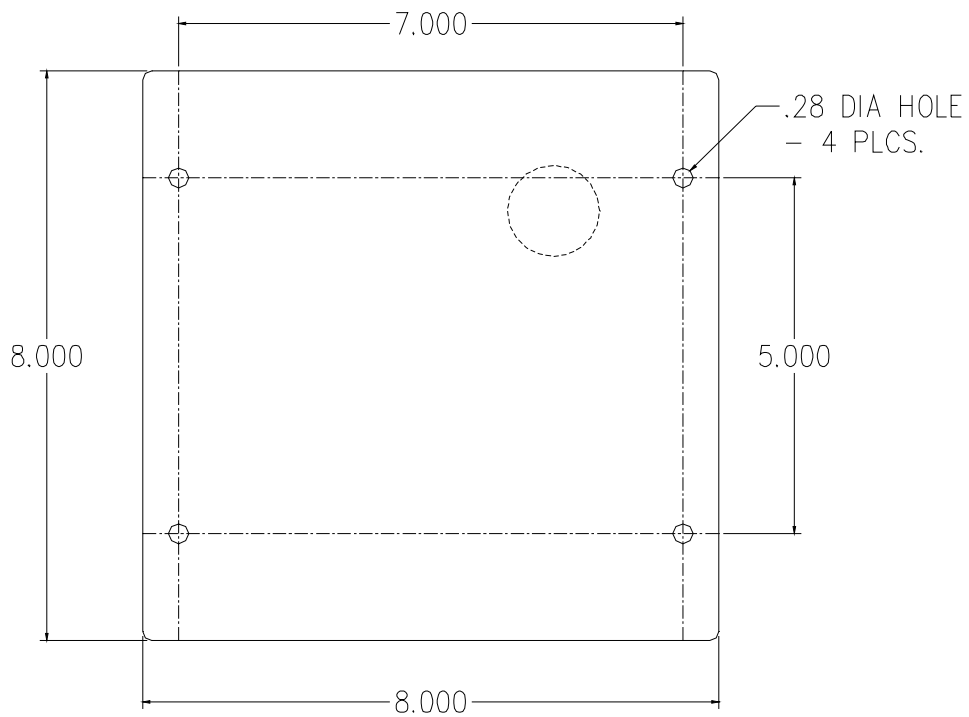

BOTTOM VIEW

OUTLINE DRAWING

INSTALLATION RECORD & WARRANTY

Date Installed _____

Installed By _____

Vehicle Identification _____

Vehicle Owner _____

WARRANTY

All products of Kussmal Electronics Company Inc. are warranted to be free of defects of material or workmanship. Liability is limited to repairing or replacing at our factory, without charge, any material or defects which become apparent in normal use within 3 years from the date the equipment was shipped. Equipment is to be returned, shipping charges prepaid and will be returned, after repair, shipping charges paid.

Kussmal Electronics Company, Inc. shall have no liability for damages of any kind to associated equipment arising from the installation and /or use of the Kussmal Electronics Company, Inc. products. The purchaser, by the acceptance of the equipment, assumes all liability for any damages which may result from its installation, use or misuse, by the purchaser, his or its employees or others.